

EXCLUSIVE OPPURTUNITY

Be one of the first home buyers in Saskatchewan to bid on five prestigious lots that afford you the freedom to custom build your dream home!



- Architecturally controlled golf course community with an assurance of quality throughout the entire subdivision
- Modern and Sustainable residences
- Fully serviced lots with water, sewer, power, gas and telecommunications
- 5 lots available ranging from .3 to .45 acres - large enough to suit any design requirements
- Close proximity to the Woodlawn Regional Park, Boundary Dam and Hidden Valley
- Invest in property that boasts of beauty, space and services



All lots will be sold on an offer to purchase basis and must be accompanied by a 5% deposit of the offer's value. * Infrastructure for the development is scheduled to begin IMMEDIATELY so call TODAY to request an offer sheet or schedule a personal tour!

LIMITED TIME OFFER

**CLOSING DATE FOR OFFERS:
JUNE 30TH, 7:00 PM**

Wilhelm Construction Services Inc. (306) 637-3230

* The developer has the right to negotiate with all offers to purchase after the closing date.

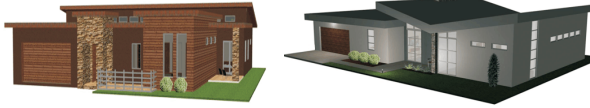

Wilhelm Construction Services Inc. is a technology driven, customer focused company. Our goal is to engage owners, developers and design professionals who desire and appreciate a contractor that "goes the extra mile."

Once your offer to purchase a Woodlawn View lot has been accepted, our team of qualified builders and architects are on call to start working with you on designing your dream estate.



- ✓ CUSTOM BUILT HOMES THAT HAVE QUALITY AND CHARACTER
- ✓ USE OF PREMIUM INTERIOR AND EXTERIOR FINISHES TO CREATE EXCLUSIVE LIVING ENVIRONMENTS THAT ARE WARM AND WELCOMING
- ✓ WALK OUT DESIGNS THAT OVERLOOK THE BEST VIEWS OF THE GOLF COURSE
- ✓ DESIGNS TO ACCOMMODATE ANYONE FROM EMPTY NESTERS TO RETIREES OR NEW FAMILIES JUST STARTING OUT!!

WWW.WILHELMCONSTRUCTION.CA

WILHELM CONSTRUCTION SERVICES INC.
PROUDLY PRESENTS...

WOODLAWN VIEW RESIDENTIAL DEVELOPMENT



Your Dream Home Awaits...
Discover the **FIRST**
residential development
of its kind to overlook
Estevan's scenic
Woodlawn Golf Course!